

FILTER OVERVIEW WITH SERVICE INTERVALS AND CAPACITIES

5E Limited Series – 5083E, 5093E, 5101E

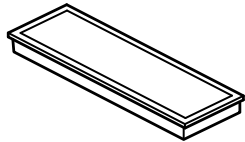

CAB

RECIRCULATION AIR FILTER – [RE195491](#)

Clean or replace after every 300 hours and as required.

Quantity 2

RECIRCULATION W/O A.C. AIR FILTER – [R198887](#)

Clean or replace after every 300 hours and as required.

Quantity 2

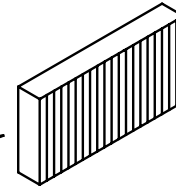

CAB

FRESH AIR FILTER – [RE198488](#)

Clean or replace after every 300 hours and as required.

Quantity 2

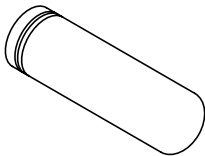

HYDRAULIC FILTER

[RE45864](#) SN (-340000)
[RE197065](#) SN (340001-)

Initial replacement 100 hours.
Replace after every 600 hours.

(Click here for [capacity](#))



FUEL FILTER – [RE522868](#)

Replace after every 300 hours.

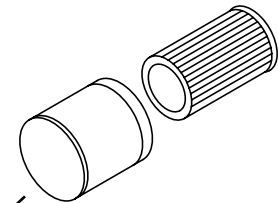

AIR

PRIMARY FILTER

[KV16429](#) SN (-340000)
[RE253518](#) SN (340001-)

SECONDARY FILTER

[AT171854](#) SN (-340000)
[RE253519](#) SN (340001-)

Replace after every 1800 hours or annually, which ever comes first.

(Service more if in extremely dusty conditions.)



OIL FILTER – [RE504836](#)

Initial replacement 100 hours.
Replace after every 300 hours.

If using Plus-50 15W-40,
replace every 450 hours.

(Click here for [capacity](#))



JOHN DEERE

Genuine Parts and Service

CAPACITIES

5E Limited Series – 5083E, 5093E, 5101E

CAPACITIES (Approximate):

Fuel Tank:

Open Operator's Station.....	96.5 L (25.5 gal)
Cab.....	126.8 L (33.5 gal)

Cooling System:

Cool-Gard II™

5E Limited Tractors.....	11.4 L (3 gal)
--------------------------	----------------

Crankcase with Filter:

Plus-50 II™

5E Limited Tractors.....	8.5 L (2.24 gal)
--------------------------	------------------

Transmission and Hydraulic System:

Hy-Gard™

5E Limited Tractors.....	43.5 L (11.5 gal)
--------------------------	-------------------

Mechanical Front Wheel Drive (MFWD) Axle:

Hy-Gard™

Differential Housing.....	4.5 L (1.18 gal)
Wheel Hub (Each).....	0.7 L (0.18 gal)

[Return to Filter Overview](#)

*For complete recommended fluid specifications please refer to the current Operations Manual.

